

带安全销-可闭合挂钩-窄型材移门锁体

Mortise sliding door lock with closeable hook with security pin

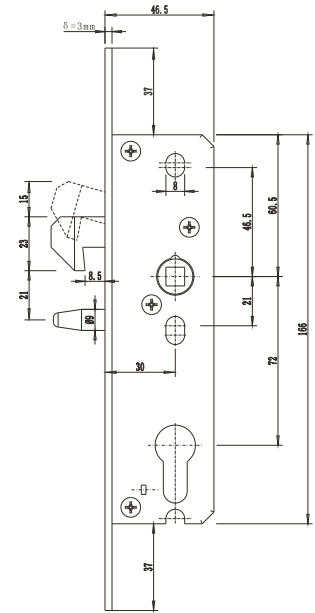
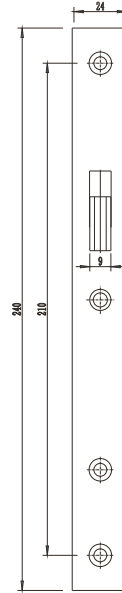
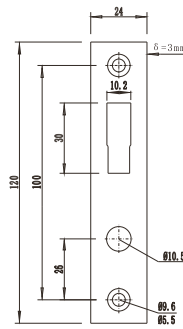
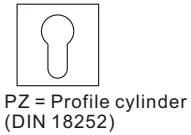

Type: H3072HCP

Mortise sliding door lock with hook-type catch

- zinc-coated lock case, face plate and strike plate , 72 mm distance. 8X8mm fixed follower in steel rings
- for raising the catch, prepared for profile cylinder with transmission

Features

Hook bolt lock with security pin

- Suitable for innerdoors and entrance doors.
- Extra security pin which makes it impossible to lift the door.
- The handle drive hook upward
- Lock the hook with the key
- Contains screw and strike plate (stainless steel).

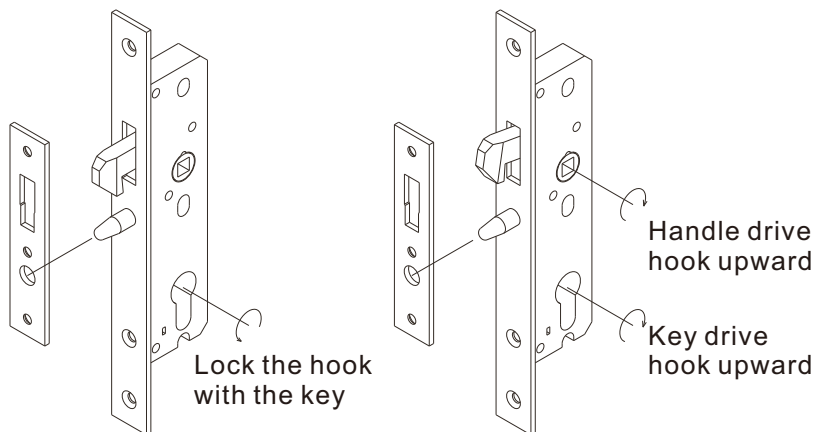

Technical data

- Follower 8X8mm
- Distance 72mm
- Backset 30mm

Forend

- Type square
- Thickness 3mm
- Width 24mm

Forend finish

- Stainless steel SSS PSS

Accessories

- Striking plate
- Fixing screws



BEIJING HSK TECHNOLOGY CO.,LTD
www.hsklock.com Email:info@houselock.com.cn TEL: 0086-10-85386092

