

ROCK 安恒通  凯胜®



<https://www.acerock.com>



Fire Rated Door Control Hardware Kaisheng Series

北京安恒利通科技股份有限公司
BEIJING HARDROCK TECHNOLOGY CO., LTD.

Beijing Hardrock Technology Co.Ltd. was set up on 2001, build self-owned brand

“ROCK, ANHENG TONG” which was awarded the famous brand in Beijing. Our company dedicated in researching, development, manufacturing and promoting traditional and intelligent hardware and become national high tech enterprise, Zhongguancun high tech enterprise. In 2015, our company became first door control industry listed on the market. With high-quality products and perfect service system, our company becomes an intensive supplier of thousands of door industries, and also to become strategic partner of top 100 listed real estate companies. To keeps pace with the times, our company vigorously promotes R&D and the production of smart locks and smart home products, to provides customers with intelligent system solutions based on internet technology.

SAFETY FOREVER EXTENSIVE

QUALITY HONESTY INNOVATION



First new three board listed company in the door control hardware industry in China

Security name: Hardrock

Security code: 831629



Beijing Hardrock is registered in Zhongguancun Science & Technology Zone, since its establishment it is a national high and new technology enterprise. The company has many registered trademarks such as "ROCK Anhengtong", Among them ROCK brand was selected "Beijing famous trademark" in 2016. Hardrock owns mature and stable R&D team, their products are independently researched, constantly innovated, it owns all the core intellectual property, among them more than 70 patents have been authorized, including more than 30 national invention patents, with a number of R&D achievements of domestic leading smart lock.



National Fire-proof Lock

Features and specifications

- Distance: 53MM
- Backset: 101.5MM
- Follower: 8MM
- Front Plate: 200X25X3MM Latch Length: 11.5MM
- Latch Thickness: 12MM Deadbolt Length: 17.5MM Latch Thickness: 12MM Lockbody Thickness: max 16MM
- Door Thickness : 40-60MM; 60-75MM

Complete Set: Lock body, Cylinder, Handle Standard accessories
 Strike plate
 Strike box
 Fixing screws
 Stainless steel GB fire proof mortise lock. Concealed screws of handle, none handing
 Pass CCCF test, 90 minutes Class A fire-proof test
 Suitable for steel doors, flush doors and rebated doors
 Suitable for fire-proof doors and smoke-proof doors

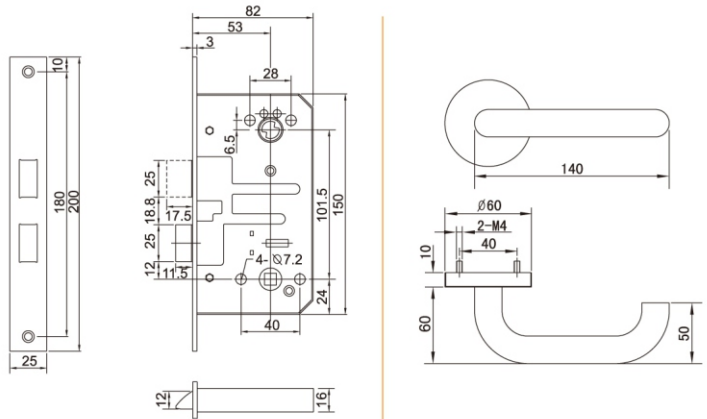

Material selection table

Product Series	Latch / Deadbolt	Front Plate & Strike Plate	Handle/ Front Plate	Model No.
G1	Iron plating (Zinc/Chrome)	Iron plating (Zinc/Chrome)	201 Stainless steel	KS80003G1
G2	201 Stainless steel	201 Stainless steel	201 Stainless steel	KS80003G2
G3	304 Stainless steel	304 Stainless steel	304 Stainless steel	KS80003G3

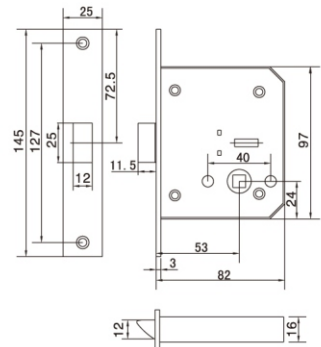
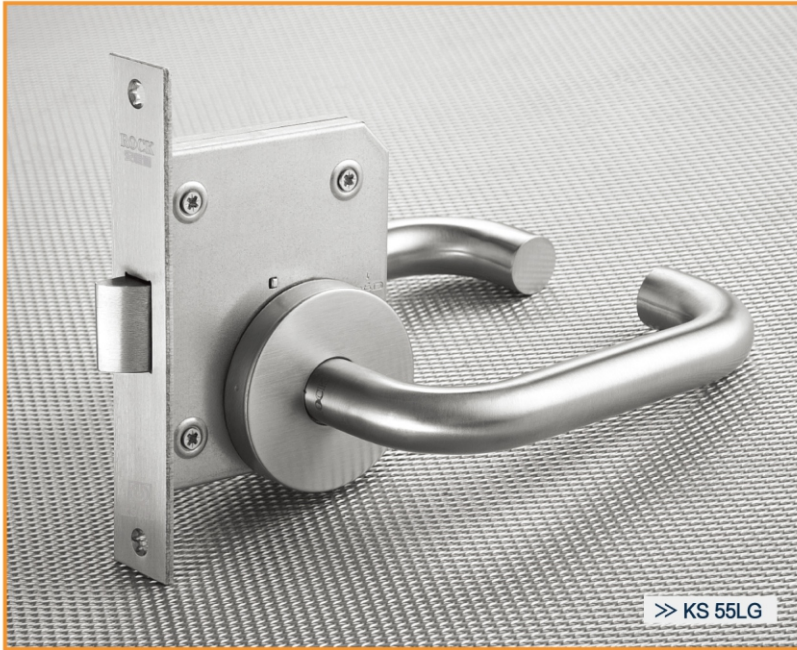

>> KS 55LG

National Fire-proof Passage Lock

Features and specifications

- Distance: 53MM
- Front Plate: 200X25X3MM
- Latch Length: 11.5MM
- Latch Thickness: 12MM
- Lockbody Thickness: max 16MM
- Door Thickness: 38-50MM; 55-65MM
- Complete Set : lockbody, handle
- Standard accessories: Strike Plate, Strike box, Fixing screws

Material selection table

Product Series	Latch	Lockbody Front Plate /Strike Plate	Handle/ Front Plate	Model No.
G1	Iron plating (Zinc/Chrome)	Iron plating (Zinc/Chrome)	201 Stainless steel	KS55NLG1
G2	201 Stainless steel	201 Stainless steel	201 Stainless steel	KS55NLG2
G3	304 Stainless steel	304 Stainless steel	304 Stainless steel	KS55NLG3

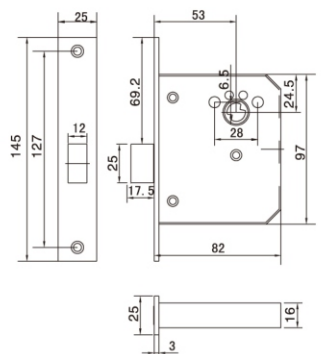

>> KS 55DG

National Fire-proof Pipe Duct Lock

Features and specifications

- Distance: 53MM
- Front Plate: 200X25X3MM
- Latch Length: 17.5MM
- Latch Thickness: 12MM
- Lock Body : max 16MM
- Door Thickness: 50-55MM
- Complete Set: Lockbody, Cylinder, Handle
- Standard accessories: Strike Plate, Strike Box, Fixing screws

Material selection table

Product Series	Deadbolt	Front Plate /Lock Strike Plate	Handle/ Front Plate	Model No.
G1	Iron plating (Zinc/Chrome)	Iron plating (Zinc/Chrome)	201 Stainless steel	KS55NDG1
G2	201 Stainless steel	201 Stainless steel	201 Stainless steel	KS55NDG2
G3	304 Stainless steel	304 Stainless steel	304 Stainless steel	KS55NDG3



>> KS 120

Fire-Proof Door Closer

Features and Specifications

Suitable for wooden and steel doors

Suitable for fire-proof doors

Passed Class A fire-proof test

CE / EN 1154 product standard

Quality assurance: service life 1 million times

Opening force: No.2 force

Door weight capacity: 25~45kg

Suitable for door width \leq 1000mm

Marking "90 degree" : with positioning function

Adjustable closing speed from 180 degree-15 degree

Adjustable latching speed from 15 degree- 0

Operating temperature: -40 °C to +60 °C

Installation: door leaf installation, door frame installation

Standard color: silver

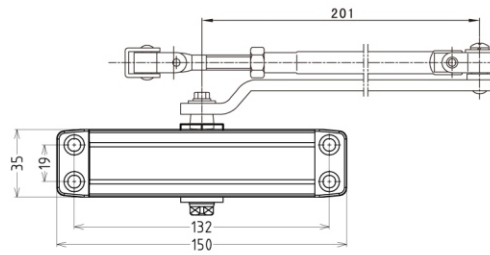



Fire-Proof Door Closer

Features and Specifications

- Suitable for wooden and steel doors
- Passed CCCF certificate and Class A fire-proof test
- CE / EN 1154 product standard
- Quality assurance: service life 1 million times
- Opening force: No.3 force
- Door weight capacity: 40~65kg
- Suitable for door width $\leq 1000\text{mm}$
- Marking "90 degree" : with positioning function
- Adjustable closing speed from 180 degree-15 degree
- Adjustable latching speed from 15 degree- 0
- Operating temperature: -40°C to $+60^{\circ}\text{C}$
- Installation: door leaf installation, door frame installation
- Standard color: silver

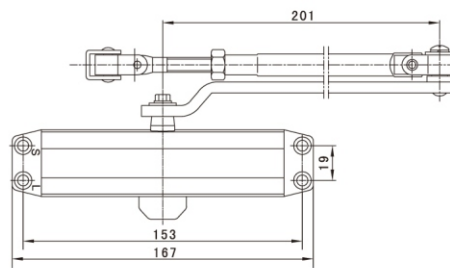

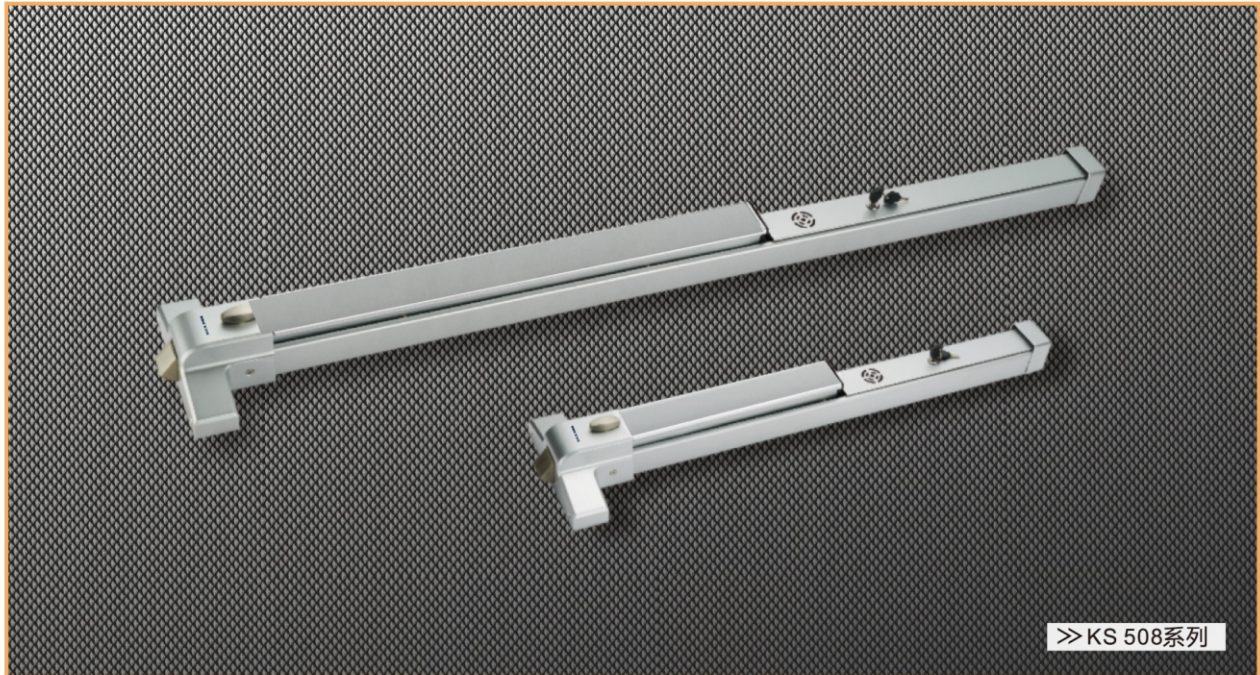

>> KS 508系列

KS 508 Series Push Bar with Smart Alarm

Features and Specifications

- Single point locking, surface mounted
- Push bar with full push rod
- With latch function
- With fire alarm function
- Adjustable lockbody length
- Suitable for single leaf door, fire rated doors, open outside, none handing
- Push to open inside, key to open outside
- Door Leaf Width \geq 650MM for KS 508, the length can be cut with any size
- Door Leaf Width \leq 650MM for KS 508M

Suitable for fire-proof door, passed Class A fire-proof test

Passed over 200,000 cycles test

Widely use in high-end office building, high-end residential, commercial building, hospital and school.

Order description

KS 508	KS 508-SS stainless steel wire drawing
	KS 508-SF iron baking paint
KS 508M	KS 508M-SS stainless steel wire drawing
	KS 508M-SF iron baking paint

Note: Please select the external handle

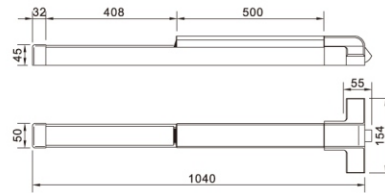

KS 508
KS 508M

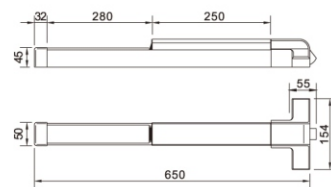

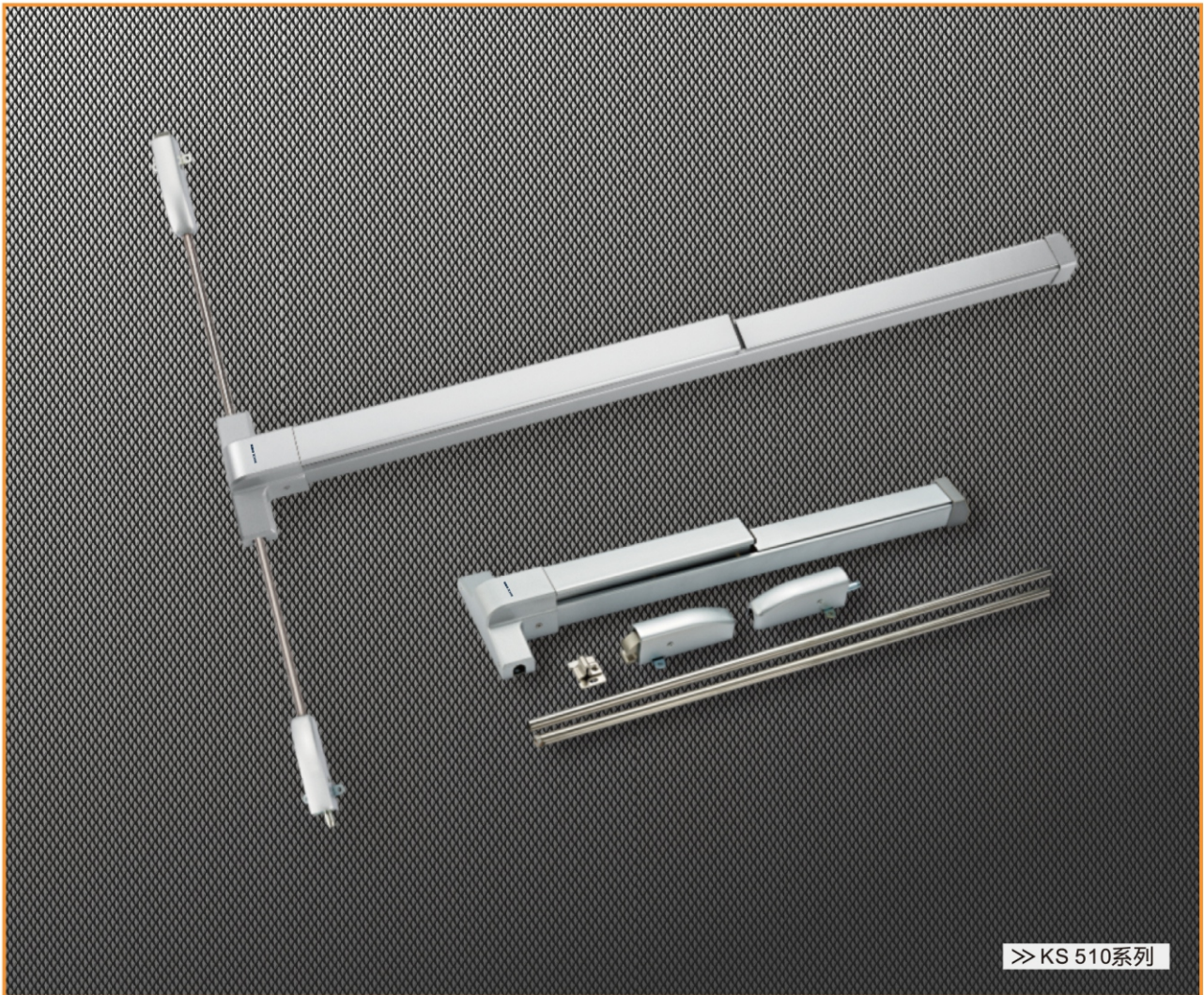

KS 510 Series Rim Exit Device Panic Lock

Function Overview

- Top and bottom two point latching, surface mounted
- Push bar with half push rod
- Suitable for double leaf door
- Fire rated doors open outside, the leaf pushing out on the right means right open and on the left means left open
- Push to open inside, key to open outside
- The rim opens while the latch retracts automatically
- Door Leaf Width \geq 650MM for KS 510, the length can be cut with any size
- Door Leaf Width \leq 650MM for KS 510M

Suitable for fire-proof door, passed Class A fire-proof test
 Passed over 200,000 cycles test
 Widely use in high-end office building, high-end residential, commercial building, hospital and school.

Order description

KS 510	KS 510-SS stainless steel wire drawing
	KS 510-SF iron baking paint
KS 510M	KS 510M-SS stainless steel wire drawing
	KS 510M-SS iron baking paint

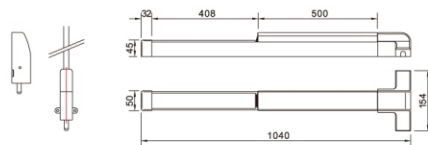

KS 510
KS 510M

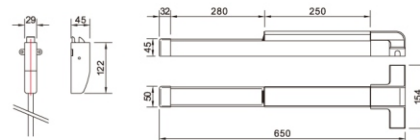

Stainless Steel Fire-proof Door Hinge

Passed 90mins fire-proof test

Passed 300,000 cycles test

Material: SUS201 stainless steel, SUS304 stainless steel

Finish: stainless steel wire drawing

Bearing hinge, flag hinge

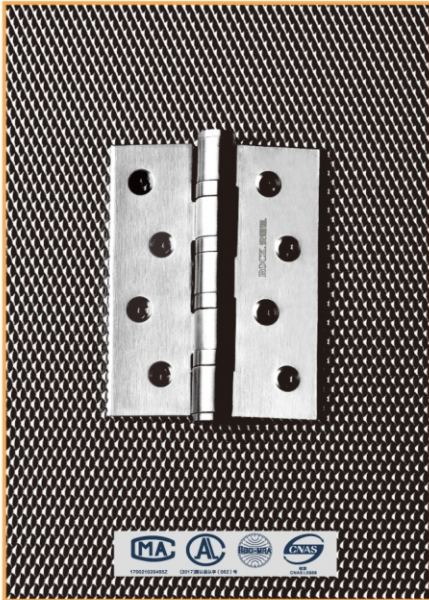

Order description

Product No. 403030-4BB

Thickness: 3mm

Accessories: M5 X 32 screws

Loading: 45-65KG

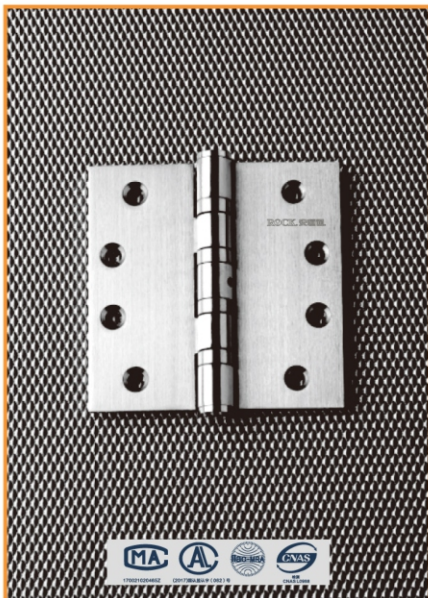

Order description

Product No: 404030-4BB

Thickness: 3mm

Accessories: M5 X 32 screws

Loading: 60-80KG

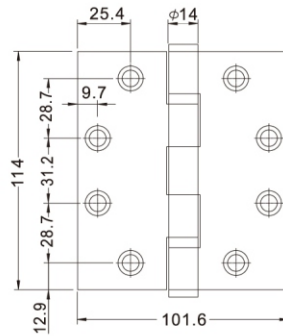
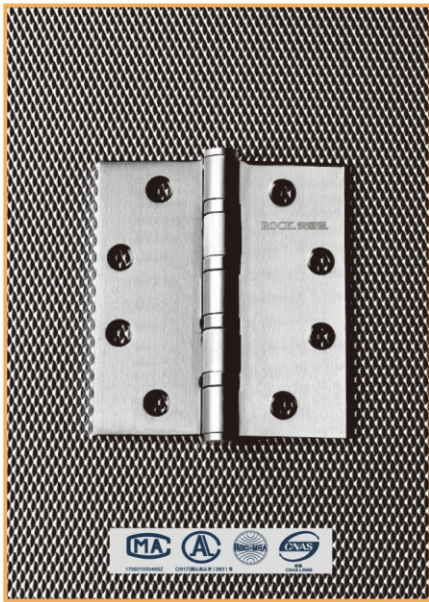

Order description

Product No. 454030-4BB
 Thickness: 3mm
 Accessories: M6 X 32 screws
 Loading: 70-85KG

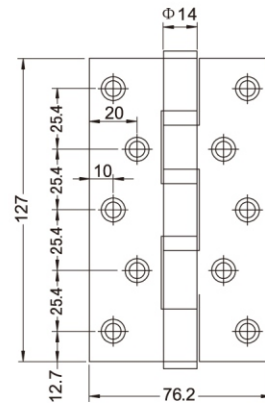

Order description

Product No. 503030-4BB
 Thickness: 3mm
 Accessories: M5 X 32 screws
 Loading: 55-75KG

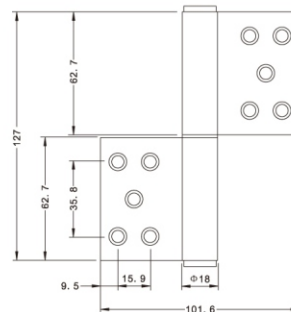

Order description

Product No: FG504030
 Thickness: 3mm
 Accessories: M5 X 32 screws
 Loading: 60-80KG

Double Door Fire-proof Co-ordinator

Functional features

- ① Suitable for double door
- ① Using with door closer
- ① Ensure double door closing order
- ① Suitable for fire-proof door, passed fire-proof test
- ① Material: Stainless steel , stainless steel wire drawing
- ① No handing

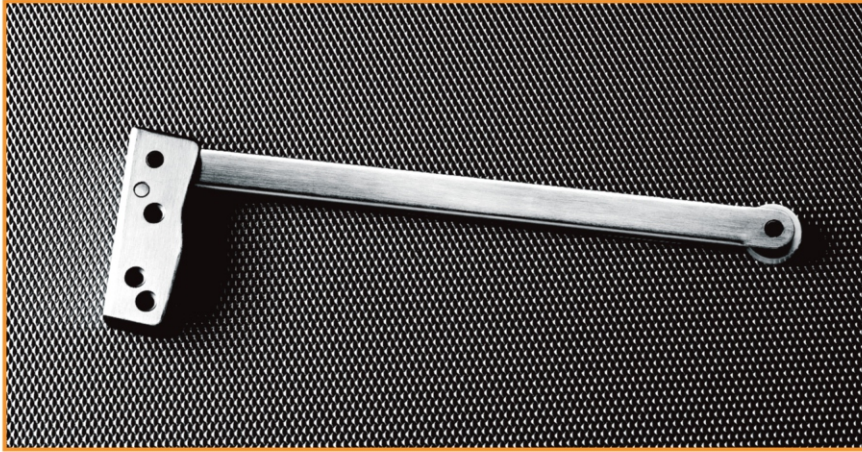

Order description

Product No.: CO 02
 Suitable for public building and high-end residential building, Fire-proof double door
 Material: 201 stainless steel
 Accessories: stainless steel wood screws
 stainless steel base screws
 Finish: stainless steel wire drawing

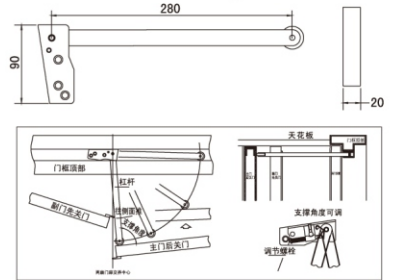

Pull and Push Plate

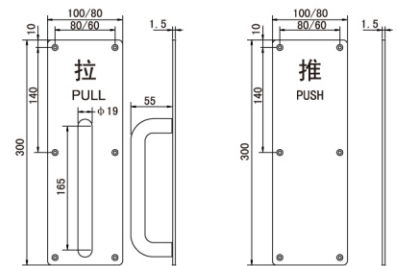
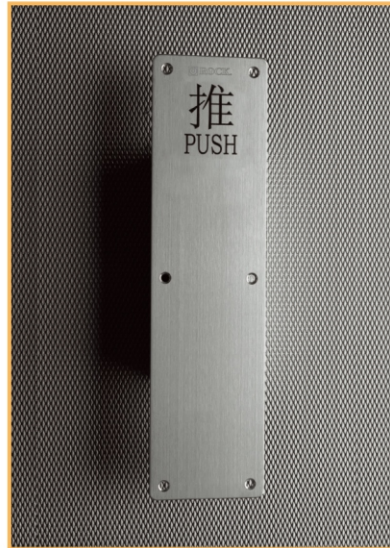

Functional features

- ① Suitable for timber and steel door
- ① Suitable for fire-proof door and smoke-proof door
- ① Letters or no letters available on push or pull plate

Order description

Product No.: 300X100, 300X80
 Thickness: 1.5MM
 Material: SUS201 stainless steel
 Accessories: Screws

Concealed bolt

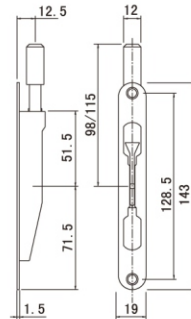
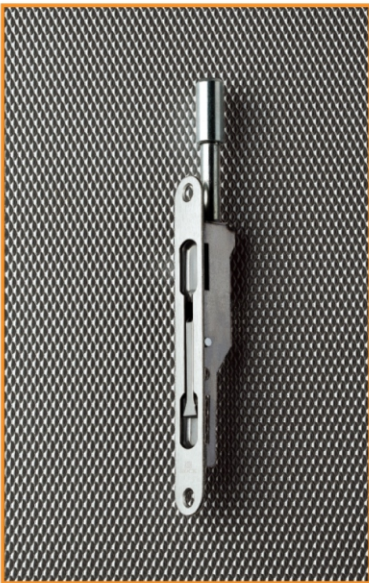

Order description

Product No.: DB02-6
 Type: special for steel door
 Length of bolt extension: 17MM
 Material: 201 stainless steel
 Accessories: connecting rod, strike plate, screw
 Packing quantity: 200 pieces/ box

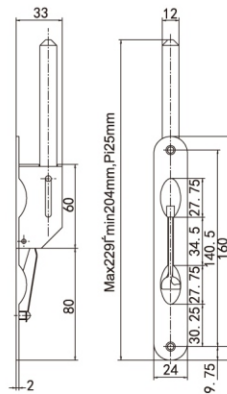

Order description

Product No.: DB02-8
 Type: special for steel door
 Length of bolt extension: 25MM
 Material: 201 stainless steel
 Accessories: connecting rod, strike plate, screw
 Packing quantity: 100 pieces/ box



Dustproof cylinder

It can be used with concealed bolt, it can replace the standard strike plate of concealed bolt, and it can effectively prevent accumulation, dust and soil.



Order description

Product No.: DS01
 Maximum diameter of pin head: 13MM
 Material: SUS 304 stainless steel
 Finish: stainless steel wire drawing



**Super scale brand inventory
Ready to deliver**

**Provide display system for
fireproof hardware solution**



ROCK. 安恒通.
中国防火门五金领军品牌
China's leading brand of fire doors
 **凯胜防火门五金系统**

北京安恒利通科技股份有限公司

**Provide display system for
fireproof hardware solution**



Beijing Hardrock Technology Co.Ltd.
Rm. 105, Dongyuan Cultural Square
No. 330 Dongxindian Chaoyang District, Beijing, China
+86 10 65202861
www.acerock.com



ENGLISH

HSK[®] International agent

BEIJING HSK TECHNOLOGY CO.,LTD

ADD:452, No.29 Building, North area of Tai
Hu, Tongzhou District, Beijing, china.
Postcode:101116
TEL: 0086-10-85386092
Email:info@houselock.com.cn
<https://www.hsklock.com>