

全封闭紧急逃生锁体

Mortise Lock Reversible, complying with DIN 18250, class 3,

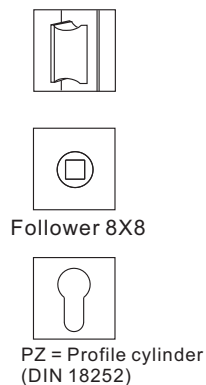

Features

- ⓘ According to DIN 18.250 class 3
- ⓘ For wooden or steel doors
- ⓘ Suitable for external fire and smoke protection doors
- ⓘ Prepared for profile cylinders
- ⓘ With key action
- ⓘ Deadbolt 1-turns

Technical data

- ⓘ Follower 8X8mm
- ⓘ Distance 72mm
- ⓘ Backset 60mm

Forend

- ⓘ Type round head, square head
- ⓘ Thickness 3mm
- ⓘ Width 20, 24mm

Forend finish

- ⓘ Stainless steel SSS PSS PVD

Accessories

- ⓘ Striking plate
- ⓘ Pocket
- ⓘ Lock and strike plate fixing screws
- ⓘ Split spindle



BEIJING HSK TECHNOLOGY CO.,LTD
 www.hsklock.com Email:info@houselock.com.cn TEL: 0086-10-85386092

Reverse left/right hand
 How to change latchbolt direction:
 Pulling up A part, latchbolt will automatically pop out; rotate 180 degree on latchbolt to complete changing direction and then press it into lock body

The transformation of inside and outside by lockbody
 How to reverse the escape function: remove the screw1 and screw 2 and then install them into the reverse side of the lock! The screws-fixing side is inside!

Function of use :
 The lever / Knob in outside is at natural state, When unlocked the door can be operated from outside by using key.
 When unlocked the door can be operated from inside without key by pushing touchbar/handle, the Escape side is in accord with Opening direction

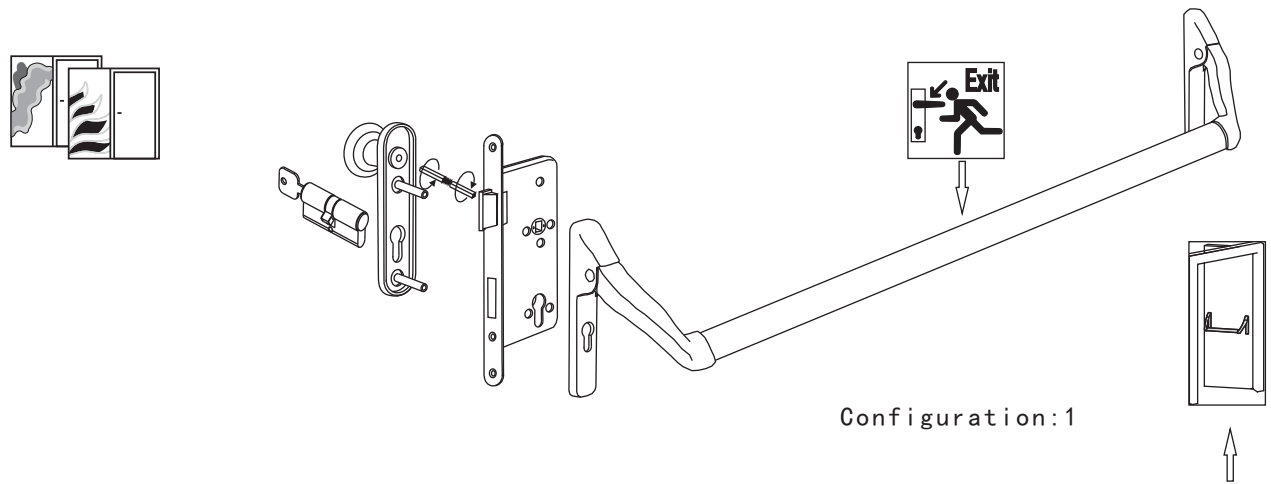

H72Z Series

Escape function lock

Mortise lock reversible

Project locks

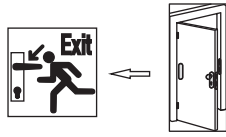

Configuration:2

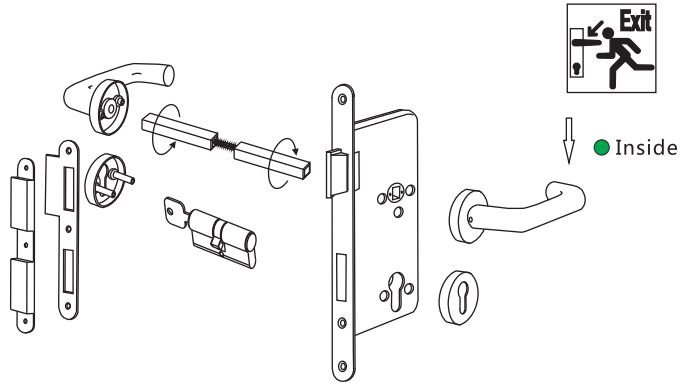

Strike plate type

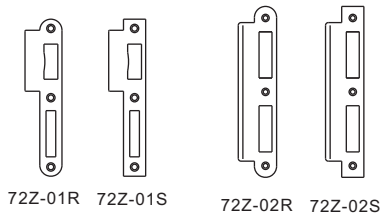

Accessories

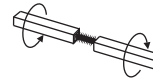

Split spindle

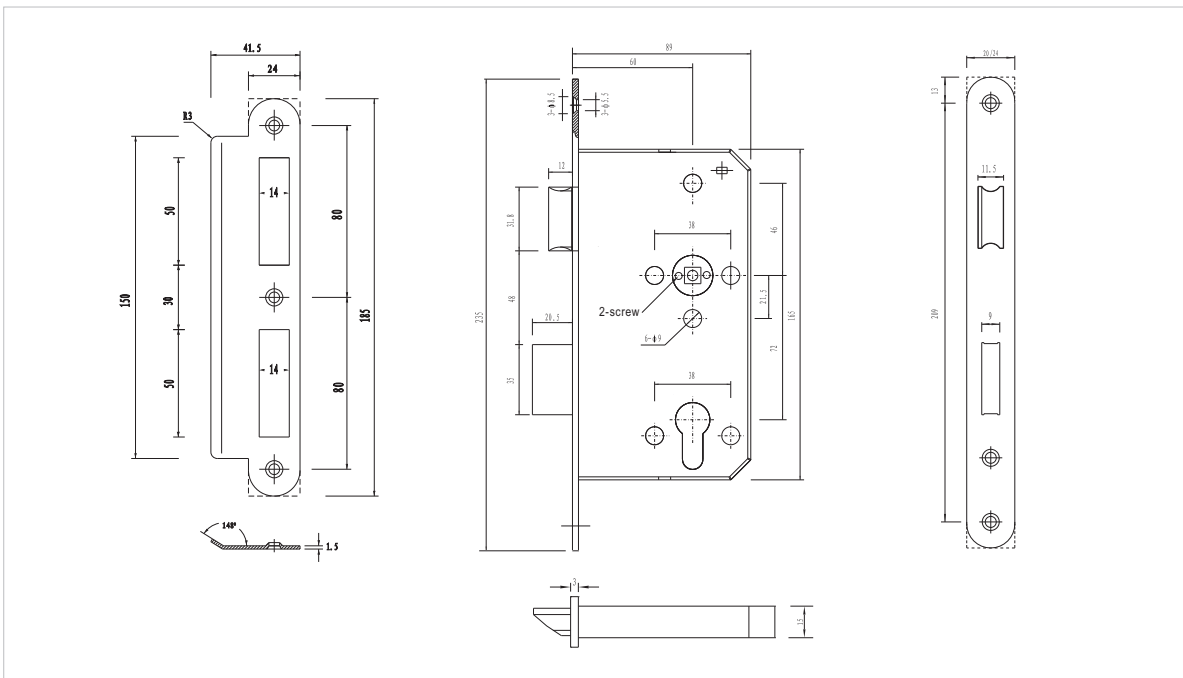

BEIJING HSK TECHNOLOGY CO.,LTD
 www.hsklock.com Email:info@houselock.com.cn TEL: 0086-10-85386092

HSK[®]
 Project locks